

**Key to Restriction Types Displayed**

— Proposed No waiting at any time

**STATUS**

Rev:	Date:	Description:	Chkd:

Reproduced from the Ordnance Survey mapping with the permission of Her Majesty's Stationery Office (© Crown copyright. Unauthorised reproduction infringes Crown copyright and may lead to prosecution or civil proceedings. Licence No. 100019422 (2022))



**TRANSPORTATION AND ENGINEERING  
NEIGHBOURHOOD SERVICES**  
Eastleigh House,  
Upper Market Street, Eastleigh,  
Hampshire. SO50 9YN  
Telephone:(023) 8068 8000  
Email:engneers@eastleigh.gov.uk

**Neighbourhood  
Services**

Scheme:  
**Damen Close**

Title:  
**TRO PROPOSALS**

Scale @ A4:      Date:      Drawn by:      Checked by:  
**NTS**                      **AGP**                      .....

Drawing No.:      Project No.:      Rev:  
**HEWEB16/08**      **VAR22-23**      .....



**Key to Restriction Types Displayed**

— Proposed No waiting at any time

**STATUS**

Status:	Description:	CHKd:

Reproduced from the Ordnance Survey mapping with the permission of Her Majesty's Stationery Office (© Crown copyright). Unauthorised reproduction infringes Crown copyright and may lead to prosecution or civil proceedings. Licence No. 100019422 (2022)



**TRANSPORTATION AND ENGINEERING  
NEIGHBOURHOOD SERVICES**  
Eastleigh House,  
Upper Market Street, Eastleigh,  
Hampshire. SO50 9YN  
Telephone:(023) 8068 8000  
Email:engneers@eastleigh.gov.uk

**Neighbourhood  
Services**

Scheme:  
Hayle Road/Eden Road

Title:  
TRO PROPOSALS

Scale @ A4: Date: Drawn by: Checked by:  
**NTS** **AGP** .....

Drawing No.: Project No.: Rev:  
**HEWEB16/05** **VAR22-23**

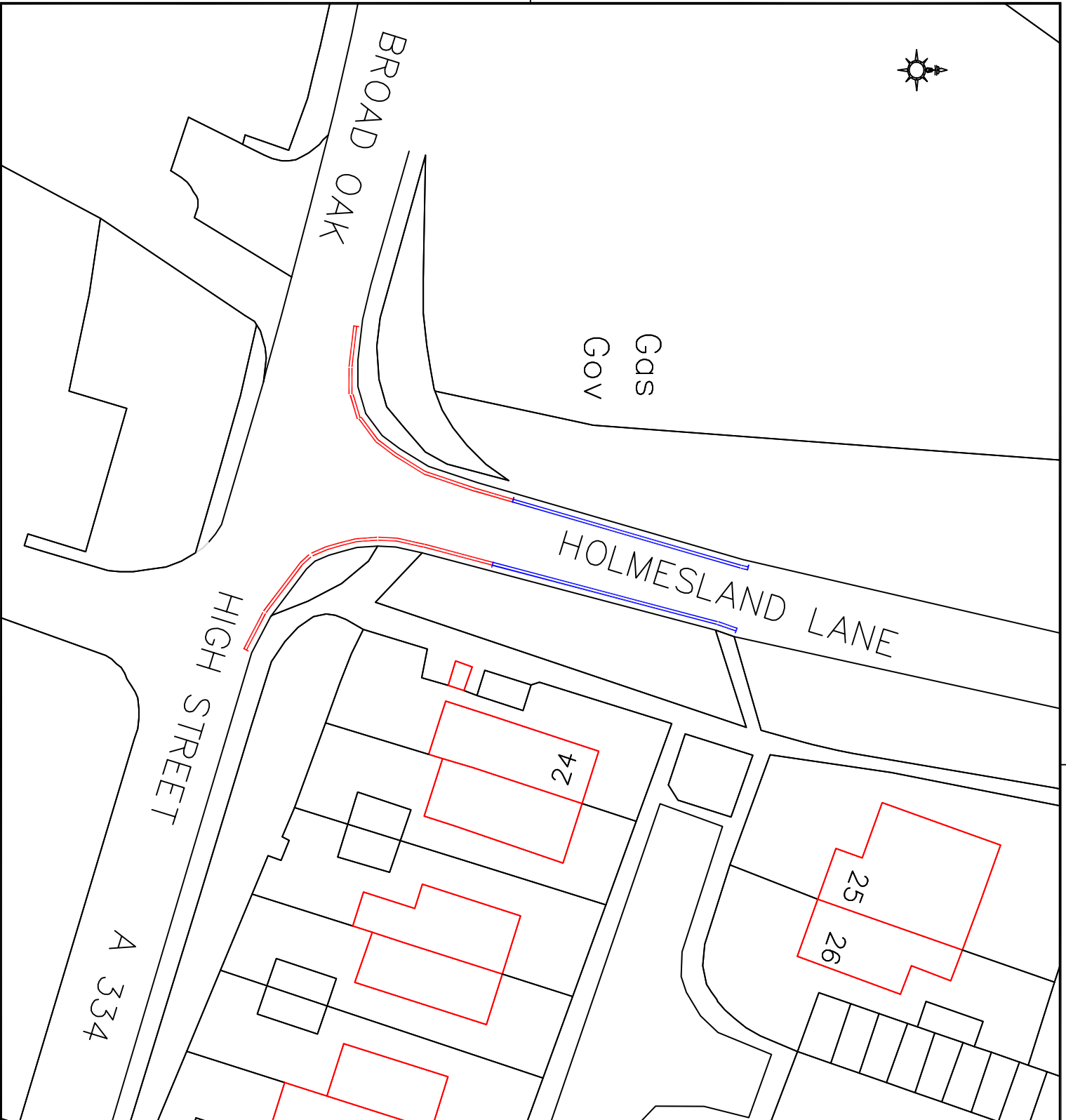

**Key to Restriction Types Displayed**

- Existing No waiting at any time
- Proposed No waiting at any time

STATUS	

Rev:	Date:	Description:	Chkd:

Reproduced from the Ordnance Survey mapping with the permission of Her Majesty's Stationery Office (© Crown copyright). Unauthorised reproduction infringes Crown copyright and may lead to prosecution or civil proceedings. License No. 100019422 (2022)



**TRANSPORTATION AND ENGINEERING**  
**NEIGHBOURHOOD SERVICES**  
 Eastleigh House,  
 Upper Market Street, Eastleigh,  
 Hampshire, SO50 9YN  
 Telephone: (023) 8068 8000  
 Email: [engneers@eastleigh.gov.uk](mailto:engneers@eastleigh.gov.uk)

**Neighbourhood Services**

Scheme:  
 Holmesland Lane

Title:  
 TRO PROPOSALS

Scale @ A4: **NTS** Date: Drawn by: **AGP** Checked by: **.....**

Drawing No.: **HEWEB16/09** Project No.: **VAR22-23** Rev:



**Key to Restriction Types Displayed**

- Proposed No waiting at any time
- Proposed No waiting 8am – 9am  
2.30pm – 4pm (MON – FRI)

**STATUS**

Rev:	Date:	Description:	CHKd:

Reproduced from the Ordnance Survey mapping with the permission of Her Majesty's Stationery Office. © Crown copyright. Unauthorised reproduction infringes Crown copyright and may lead to prosecution or civil proceedings. License No. 100019622 (2022)



**TRANSPORTATION AND ENGINEERING  
NEIGHBOURHOOD SERVICES**  
Eastleigh House,  
Upper Market Street, Eastleigh,  
Hampshire, SO50 9YN  
Telephone: (023) 8068 8000  
Email: [engineers@eastleigh.gov.uk](mailto:engineers@eastleigh.gov.uk)

**Neighbourhood  
Services**

Scheme:  
Jasmine Road/Tamarisk Road

**TRO PROPOSALS**

Scale @ A4:	Date:	Drawn by:	Checked by:
<b>NTS</b>		<b>AGP</b>	.....
Drawing No.:	Project No.:	Rev.:	
<b>HEWEB16/14</b>	<b>VAR22-23</b>		

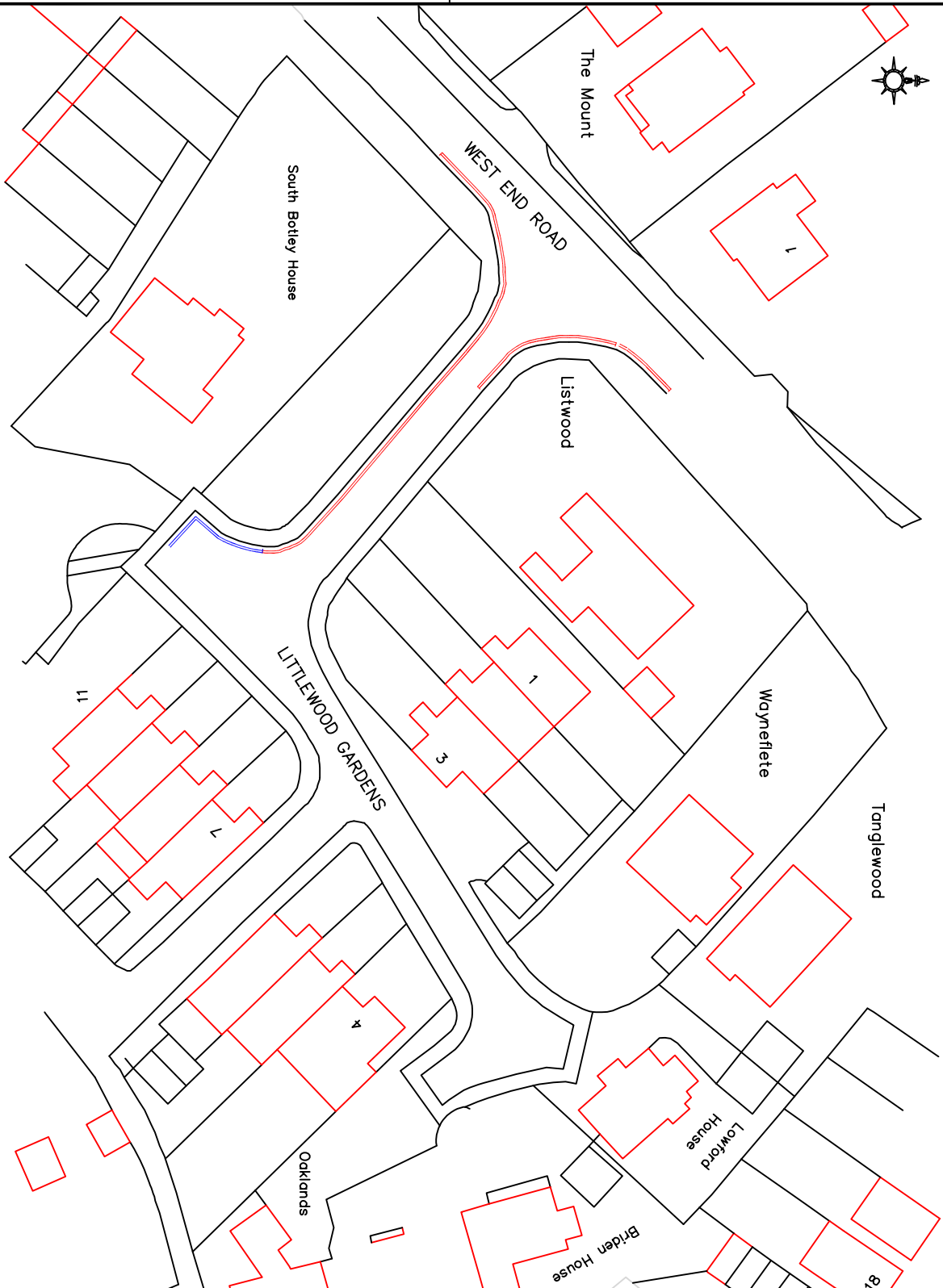

**Key to Restriction Types Displayed**

- Existing No waiting at any time
- Proposed No waiting at any time

Status: STATUS

Rev:	Date:	Description:	Chkd:

Reproduced from the Ordnance Survey mapping with the permission of Her Majesty's Stationery Office. Crown copyright. Unauthorised reproduction infringes Crown copyright and may lead to prosecution or civil proceedings. License No. 100019622 (2022)



**TRANSPORTATION AND ENGINEERING  
NEIGHBOURHOOD SERVICES**

Eastleigh House,  
Upper Market Street, Eastleigh,  
Hampshire, SO50 9YN  
Telephone: (023) 8068 8000  
Email: [engneers@eastleigh.gov.uk](mailto:engneers@eastleigh.gov.uk)

**Neighbourhood  
Services**

Scheme:  
Littlewood Gardens

Title:  
TRO PROPOSALS

Scale @ A4: Date: Drawn by: Checked by:

**NTS** **AGP** .....

Drawing No.: Project No.: Rev:

**HEWEB16/06** **VAR22-23** .....



- Key to Restriction Types Displayed**
- Existing No waiting at any time
  - Proposed No waiting at any time

STATUS		
Status:		

Rev:	Date:	Description:	Chkd:

Reproduced from the Ordnance Survey mapping with the permission of Her Majesty's Stationery Office. Crown copyright. Unauthorised reproduction infringes Crown copyright and may lead to prosecution or civil proceedings. License No. 100019422 (2022)



**TRANSPORTATION AND ENGINEERING  
NEIGHBOURHOOD SERVICES**

Eastleigh House,  
Upper Market Street, Eastleigh,  
Hampshire, SO50 9YN  
Telephone: (023) 8068 8000  
Email: [engneers@eastleigh.gov.uk](mailto:engneers@eastleigh.gov.uk)

**Neighbourhood  
Services**

Scheme:  
**Lyons Place**

Title:  
**TRO PROPOSALS**

Scale @ A4: <b>NTS</b>	Date:	Drawn by: <b>AGP</b>	Checked by:
Drawing No.: <b>HEWEB16/02</b>	Project No.: <b>VAR22-23</b>	Rev:	



EXISTING  
PARKING BAYS  
TO BE REMOVED

MARVIN WAY

MARLS ROAD

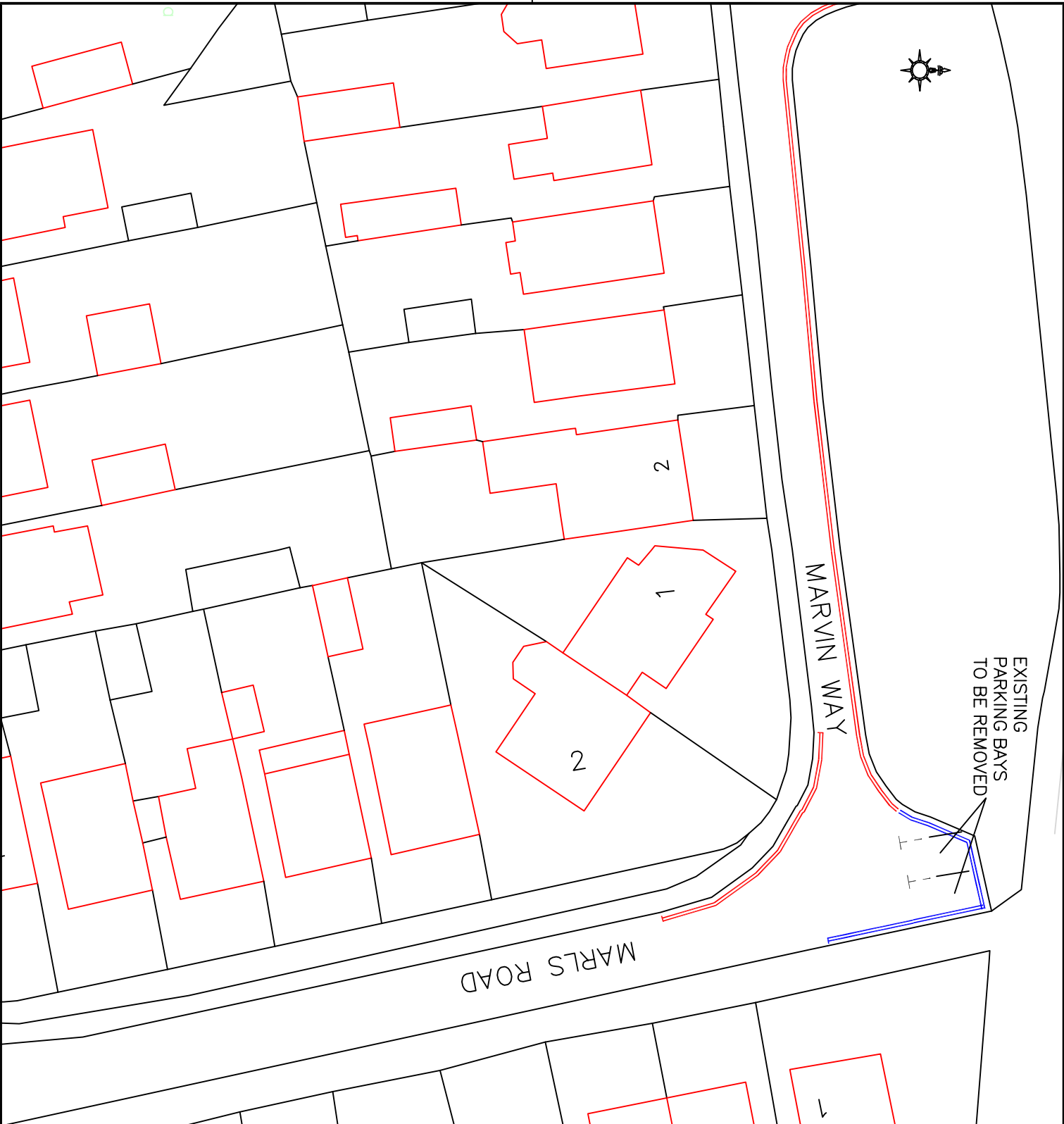

Key to Restriction Types Deployed

- Existing No waiting at any time
- Proposed No waiting at any time

Status: STATUS

Rev:	Date:	Description:	Chkd:

Reproduced from the Ordnance Survey mapping with the permission of Her Majesty's Stationery Office (© Crown copyright). Unauthorised reproduction infringes Crown copyright and may lead to prosecution or civil proceedings. License No. 100019622 (2022)



**TRANSPORTATION AND ENGINEERING**  
**NEIGHBOURHOOD SERVICES**  
 Eastleigh House,  
 Upper Market Street, Eastleigh,  
 Hampshire. SO50 9YN  
 Telephone: (023) 8068 8000  
 Email: engin@eastleigh.gov.uk

**Neighbourhood Services**

Scheme: Marls Road

Title: TRO PROPOSALS

Scale @ A4:	Date:	Drawn by:	Checked by:
NTS		AGP	.....
Drawing No.:	Project No.:	Rev:	
HEWEB16/10	VAR22-23		





**Key to Restriction Types Displayed**

— Proposed No waiting at any time

**Status:**

STATUS

Rev:	Date:	Description:	CHKd:

Reproduced from the Ordnance Survey mapping with the permission of Her Majesty's Stationery Office (© Crown copyright). Unauthorised reproduction infringes Crown copyright and may lead to prosecution or civil proceedings. License No. 100019422 (2022)



**TRANSPORTATION AND ENGINEERING  
NEIGHBOURHOOD SERVICES**  
Eastleigh House,  
Upper Market Street, Eastleigh,  
Hampshire. SO50 9YN  
Telephone:(023) 8068 8000  
Email:engneers@eastleigh.gov.uk

**Neighbourhood  
Services**

Scheme:  
Romill Close

Title:  
TRO PROPOSALS

Scale @ A4: Date: Drawn by: Checked by:  
**NTS** **AGP** .....

Drawing No.: Project No.: Rev:  
**HEWEB16/03** **VAR22-23.**



**Key to Restriction Types Displayed**

- Existing No waiting at any time
- Proposed No waiting at any time

**STATUS**

Rev:	Date:	Description:	Chkd:

Reproduced from the Ordnance Survey mapping with the permission of Her Majesty's Stationery Office (© Crown copyright). Unauthorised reproduction infringes Crown copyright and may lead to prosecution or civil proceedings. License No. 100019422 (2022)



**TRANSPORTATION AND ENGINEERING  
NEIGHBOURHOOD SERVICES**  
Eastleigh House,  
Upper Market Street, Eastleigh,  
Hampshire. SO50 9YN  
Telephone: (023) 8068 8000  
Email: [engineers@eastleigh.gov.uk](mailto:engineers@eastleigh.gov.uk)

**Neighbourhood  
Services**

Scheme:  
**Trent Way/Severn Way**

Title:  
**TRO PROPOSALS**

Scale @ A4: **NTS** Date: Drawn by: **AGP** Checked by: **.....**

Drawing No.: **HEWEB16/11** Project No.: **VAR22-23** Rev:



**Key to Restriction Types Displayed**

— Proposed No waiting at any time

Status:	STATUS

Rev:	Date:	Description:	Chkd:

Reproduced from the Ordnance Survey mapping with the permission of Her Majesty's Stationery Office (© Crown copyright). Unauthorised reproduction infringes Crown copyright and may lead to prosecution or civil proceedings. License No. 100019422 (2022)



**TRANSPORTATION AND ENGINEERING  
NEIGHBOURHOOD SERVICES**  
Eastleigh House,  
Upper Market Street, Eastleigh,  
Hampshire, SO50 9YN  
Telephone: (023) 8068 8000  
Email: [engneers@eastleigh.gov.uk](mailto:engneers@eastleigh.gov.uk)

**Neighbourhood  
Services**

Scheme:  
**Watson Court**

Title:  
**TRO PROPOSALS**

Scale @ A4: **NTS** Date: Drawn by: **AGP** Checked by: **.....**

Drawing No.: **HEWEB16/17** Project No.: **VAR22-23** Rev: