

Key to Restriction Types Displayed

— Proposed "No Waiting at any Time"

Status:	STATUS
---------	--------

Rev:	Date:	Description:	Chkd:

Reproduced from the Ordnance Survey mapping with the permission of Her Majesty's Stationery Office (© Crown copyright). Unauthorised reproduction infringes Crown copyright and may lead to prosecution or civil proceedings. License No. 100019022 (2022)



TRANSPORTATION AND ENGINEERING
NEIGHBOURHOOD SERVICES
 Eastleigh House,
 Upper Market Street, Eastleigh,
 Hampshire, SO50 9YN
 Telephone: (023) 8068 8000
 Email: englineers@eastleigh.gov.uk

Neighbourhood Services

Scheme:
 Abbotsbury Rd/Torwood Gdns

Title:
 TRO PROPOSALS

Scale @ A4: NTS	Date:	Drawn by: AGP	Checked by:
Drawing No.: BIF0HH13/010	Project No.: VAR22-23	Rev:	

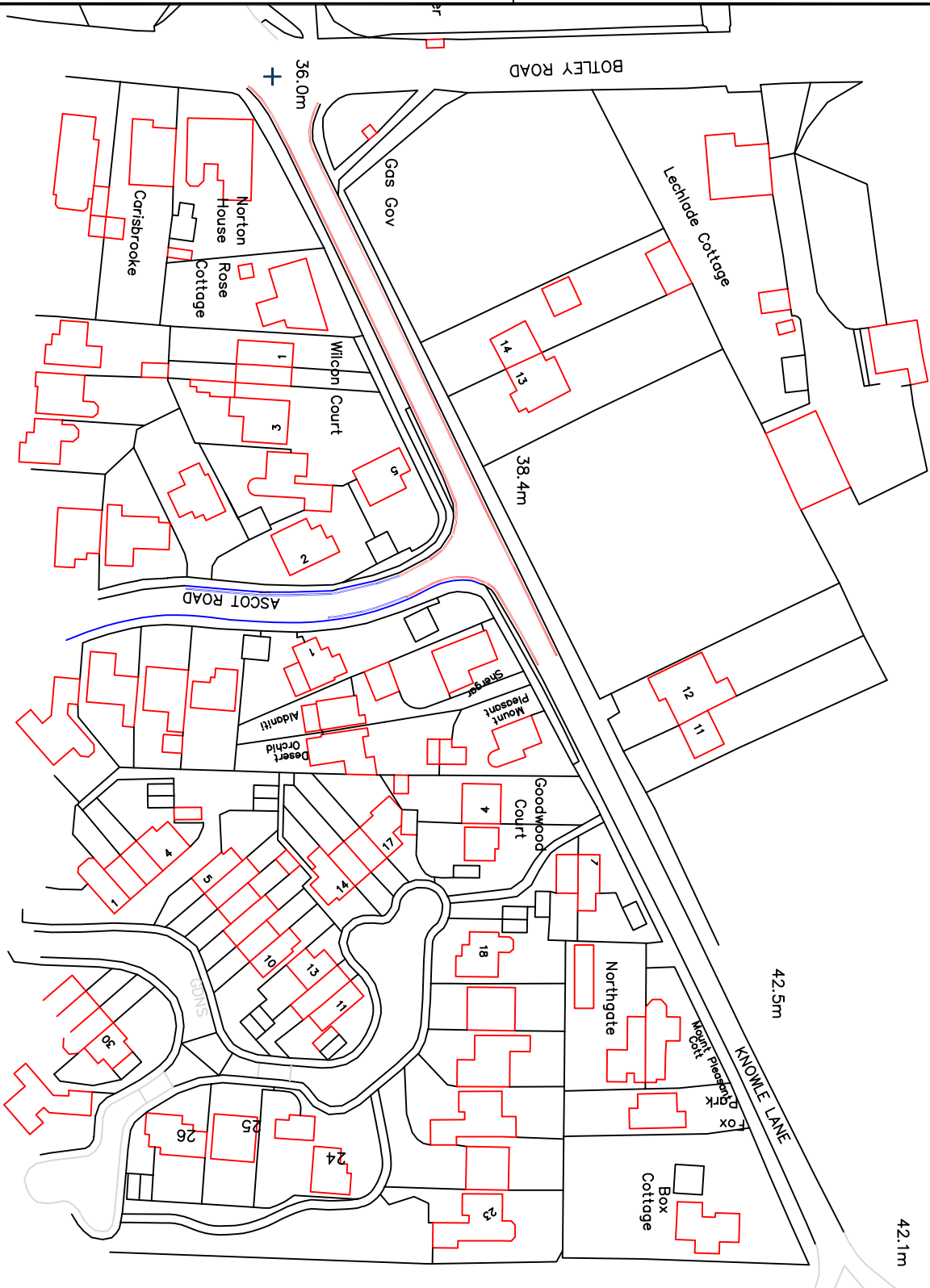

Key to Restriction Types Displayed

- Existing "No Waiting at any Time"
- Proposed "No Waiting at any Time"

STATUS		
Status:		

Rev.	Date:	Description:	Chkd:

Reproduced from the Ordnance Survey mapping with the permission of Her Majesty's Stationery Office (© Crown copyright). Unauthorised reproduction infringes Crown copyright and may lead to prosecution or civil proceedings. Licence No. 100019022 (2022)



**TRANSPORTATION AND ENGINEERING
NEIGHBOURHOOD SERVICES**
 Eastleigh House,
 Upper Market Street, Eastleigh,
 Hampshire. SO50 9YN
 Telephone:(023) 8068 8000
 Email:engneers@eastleigh.gov.uk

**Neighbourhood
Services**

Scheme:
Knowle Lane

Title:
TRO PROPOSALS

Scale @ A4: Date: Drawn by: Checked by:
NTS AGP

Drawing No.: Project No.: Rev:
 Bf0HH13/001 VAR22-23.

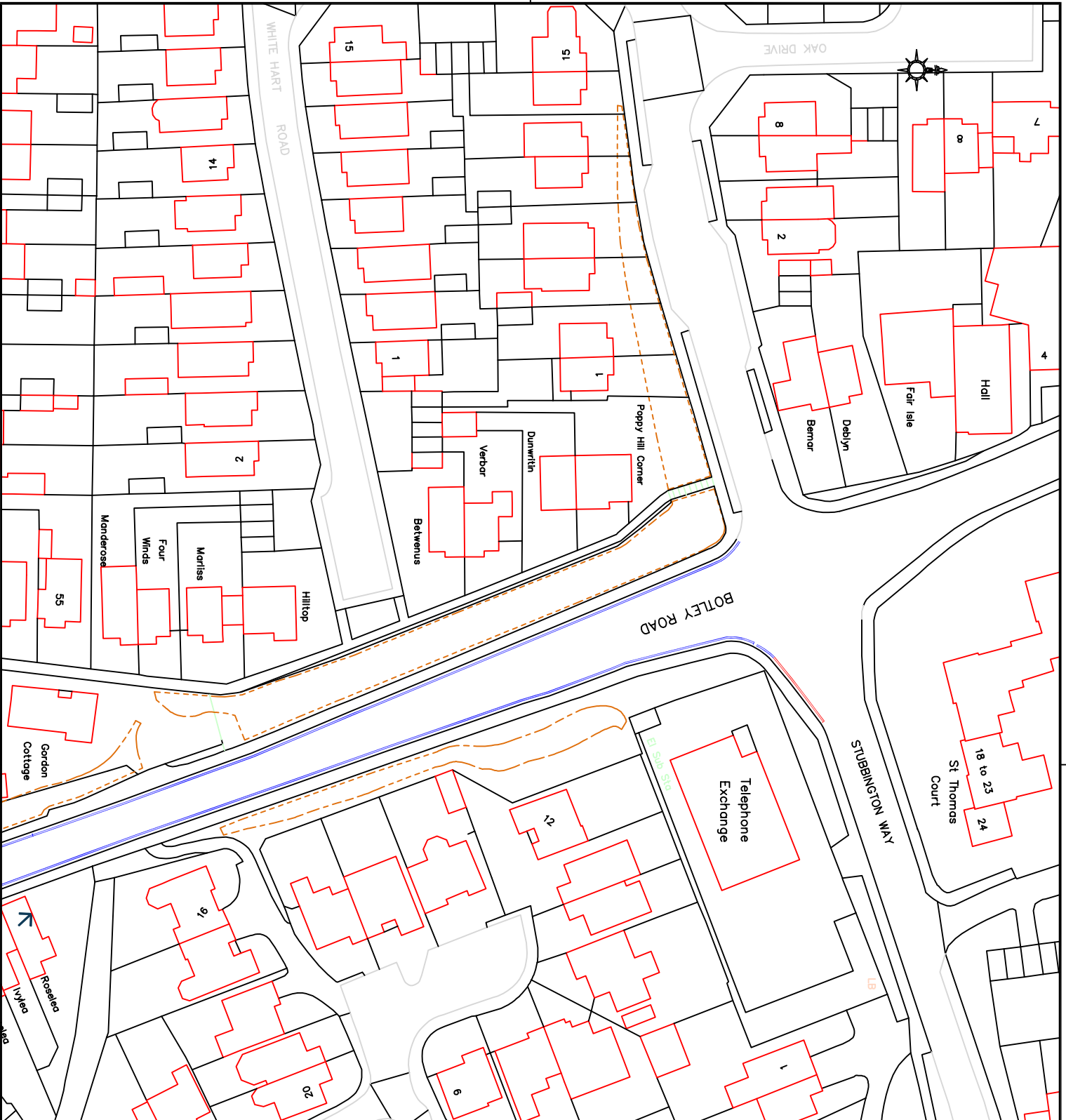

Key to Restriction Types Displayed

- Existing "At any Time" Restrictions
- Proposed "At any Time" Restrictions

STATUS

Rev:	Date:	Description:	Chkd:

Reproduced from the Ordnance Survey mapping with the permission of Her Majesty's Stationery Office (© Crown copyright). Unauthorised reproduction infringes Crown copyright and may lead to prosecution or civil proceedings. License No. 100019022 (2022)



**TRANSPORTATION AND ENGINEERING
NEIGHBOURHOOD SERVICES**
Eastleigh House,
Upper Market Street, Eastleigh,
Hampshire, SO50 9YN
Telephone: (023) 8068 8000
Email: engneers@eastleigh.gov.uk

**Neighbourhood
Services**

Scheme:
Botley Road Page 1

Title:
TRO PROPOSALS

Scale @ A4: **NTS** Date: Drawn by: **AGP** Checked by: **.....**

Drawing No.: **BIF0HH13/003** Project No.: **VAR22-23** Rev:

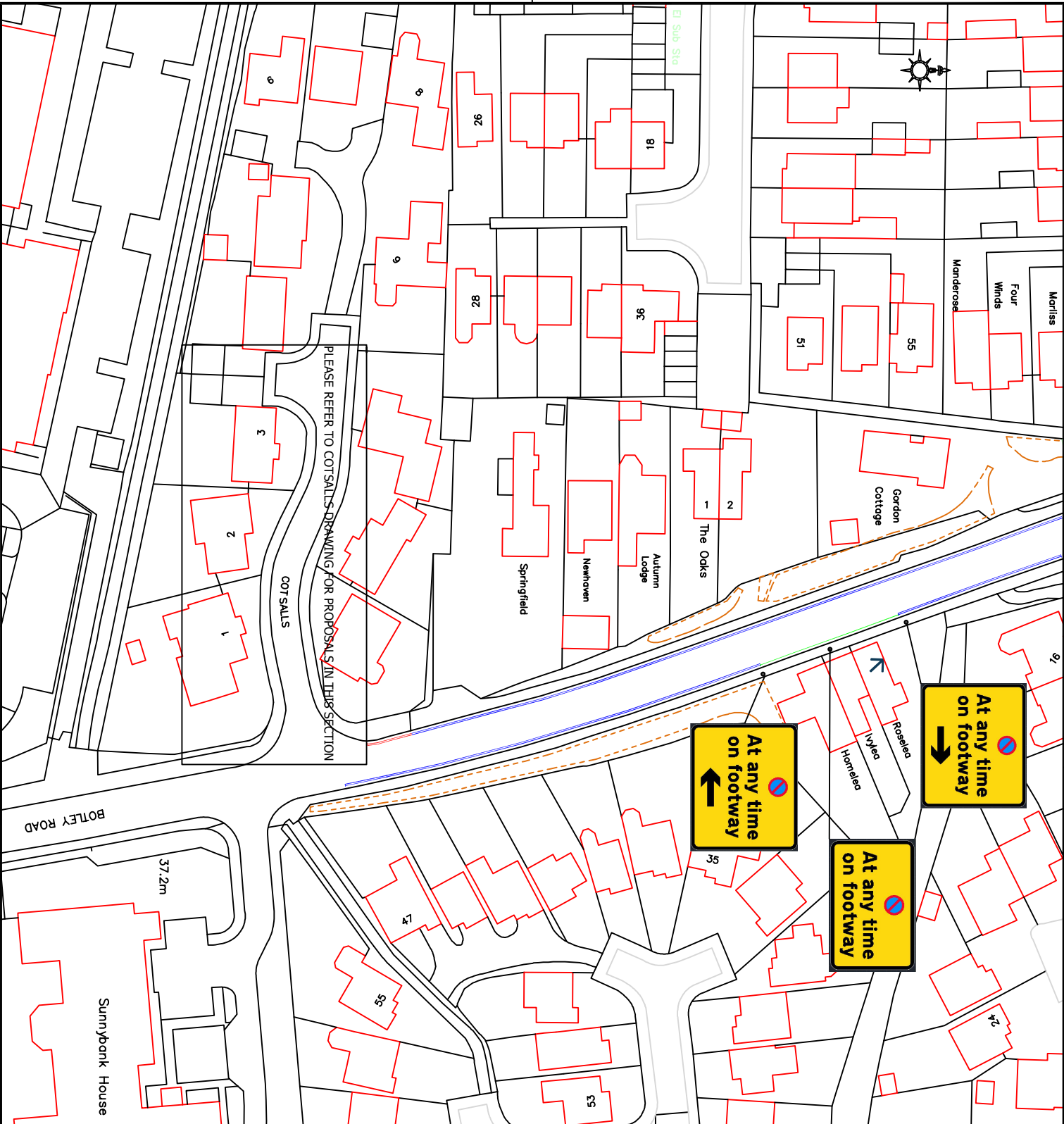

At any time on footway
 →

At any time on footway
 ←

At any time on footway

Key to Restriction Types Displayed

- Existing "At any Time" Restrictions
- Proposed "At any Time" Restrictions
- Proposed "No Parking on verge or Footway"

Status:	STATUS

Rev:	Date:	Description:	CHKd:

Reproduced from the Ordnance Survey mapping with the permission of Her Majesty's Stationery Office (© Crown copyright). Unauthorised reproduction infringes Crown copyright and may lead to prosecution or civil proceedings. Licence No. 100019022 (2022)



**TRANSPORTATION AND ENGINEERING
 NEIGHBOURHOOD SERVICES**
 Eastleigh House,
 Upper Market Street, Eastleigh,
 Hampshire. SO50 9YN
 Telephone: (023) 8068 8000
 Email: engneers@eastleigh.gov.uk

**Neighbourhood
 Services**

Scheme:
 Botley Road Page 2

Title:
 TRO PROPOSALS

Scale @ A4: NTS	Date:	Drawn by: AGP	Checked by:
Drawing No.: BfC0H13/003B	Project No.: VAR22-23	Rev:	

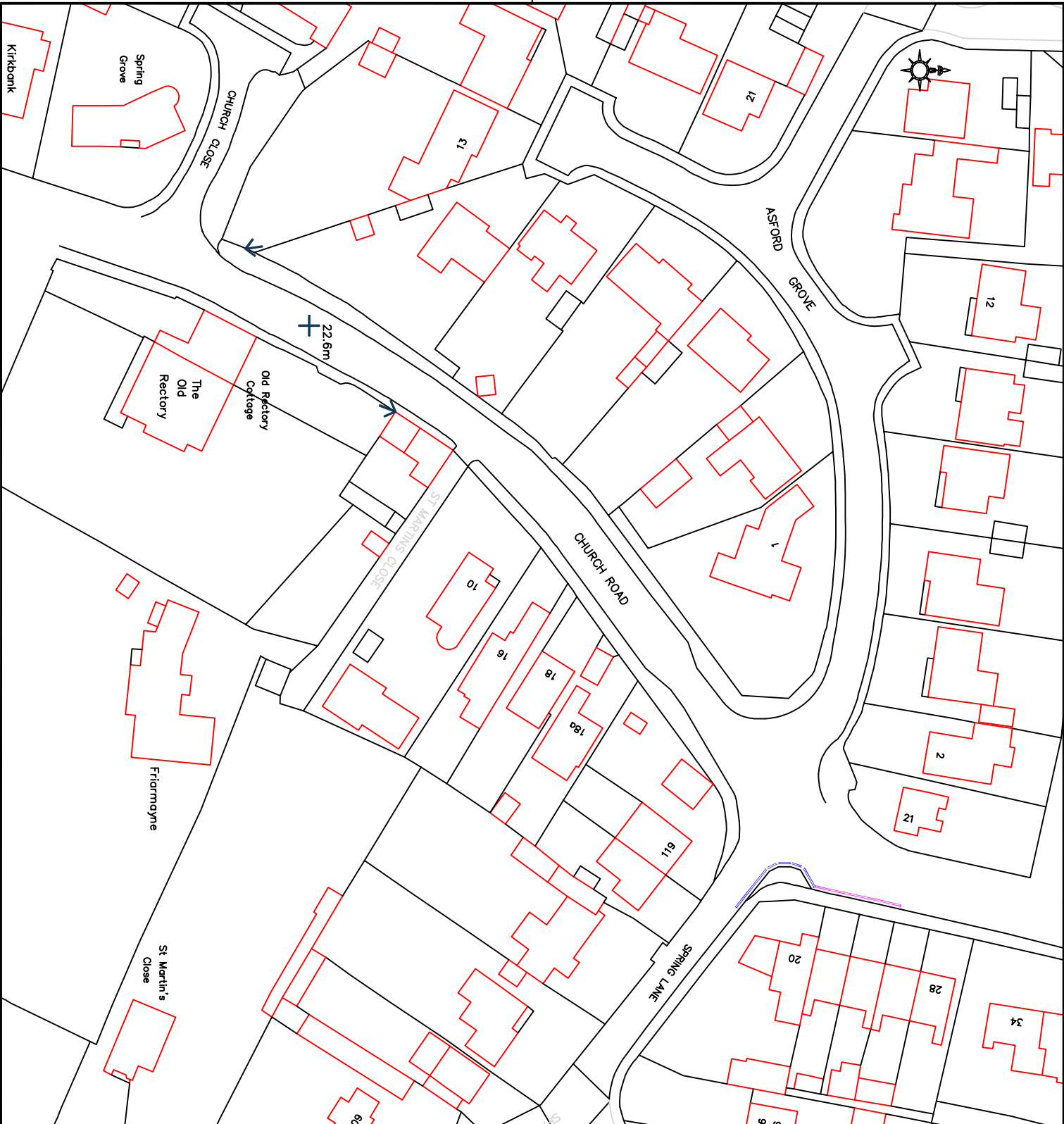

- Key to Restriction Types Displayed**
- Existing "No Waiting at any Time" To be revoked
 - Proposed "No Waiting at any Time"

STATUS		
Status:		

Rev:	Date:	Description:	Chkd:

Reproduced from the Ordnance Survey mapping with the permission of Her Majesty's Stationery Office. Crown copyright. Unauthorised reproduction infringes Crown copyright and may lead to prosecution or civil proceedings. License No. 100019422 (2022)



**TRANSPORTATION AND ENGINEERING
NEIGHBOURHOOD SERVICES**

Eastleigh House,
Upper Market Street, Eastleigh,
Hampshire, SO50 9YN
Telephone: (023) 8068 8000
Email: engneers@eastleigh.gov.uk

**Neighbourhood
Services**

Scheme:
Church Road / Spring Lane

Title:
TRO PROPOSALS

Scale @ A4: Date: Drawn by: Checked by:

NTS **AGP**

Drawing No.: Project No.: Rev:

BIF-0H13/0011 VAR22-23.

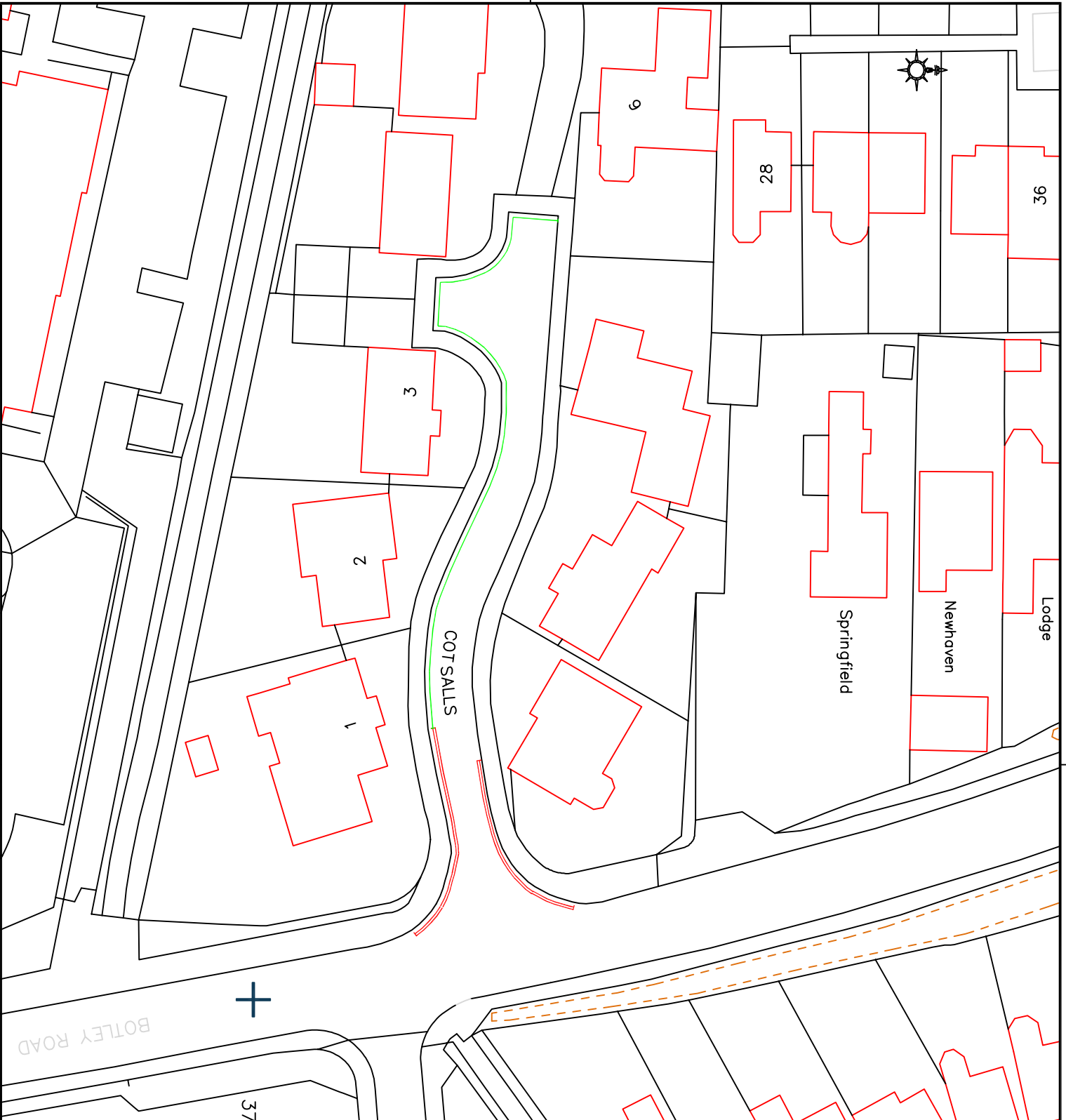

Key to Restriction Types Displayed

- Existing "No Waiting at any Time"
- Proposed restrictions 8am – 9am
2.30pm – 4.00pm Mon – Fri

Status: STATUS

Rev:	Date:	Description:	Chkd:

Reproduced from the Ordnance Survey mapping with the permission of Her Majesty's Stationery Office (© Crown copyright). Unauthorised reproduction infringes Crown copyright and may lead to prosecution or civil proceedings. License No. 100019422 (2022)



TRANSPORTATION AND ENGINEERING
NEIGHBOURHOOD SERVICES
 Eastleigh House,
 Upper Market Street, Eastleigh,
 Hampshire, SO50 9YN
 Telephone: (023) 8068 8000
 Email: engneers@eastleigh.gov.uk

Neighbourhood Services

Scheme: Cotalls

Title: TRO PROPOSALS

Scale @ A4: Date: Drawn by: Checked by:
NTS **AGP**

Drawing No.: Project No.: Rev:
 BIFoHH 13 / 002 VAR22-23.

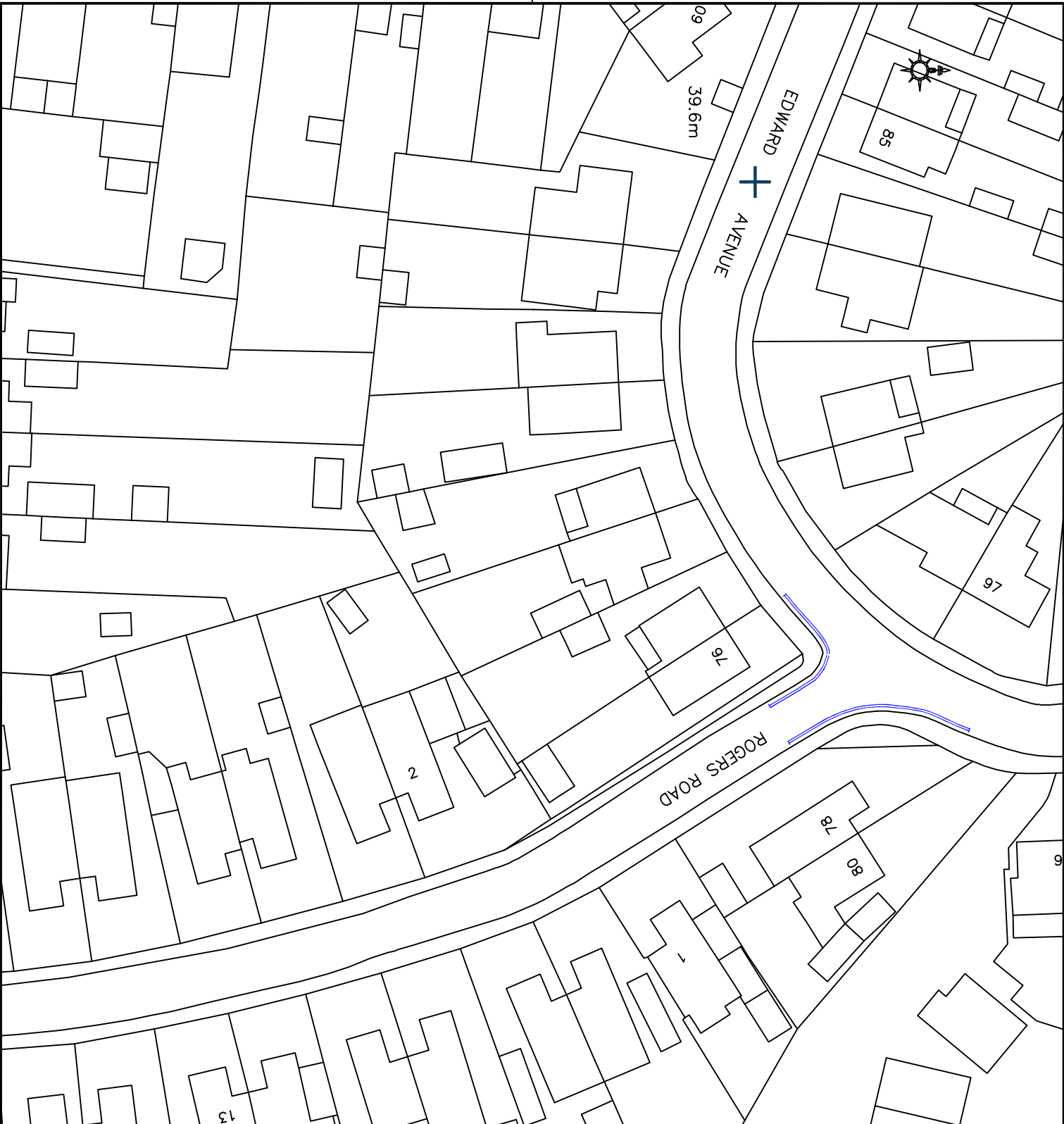

Key to Restriction Types Displayed

— Proposed "No Waiting at any Time"

STATUS

Rev:	Date:	Description:	Chkd:

Reproduced from the Ordnance Survey mapping with the permission of Her Majesty's Stationery Office (© Crown copyright). Unauthorised reproduction infringes Crown copyright and may lead to prosecution or civil proceedings. License No. 100019422 (2022)



TRANSPORTATION AND ENGINEERING
NEIGHBOURHOOD SERVICES
Eastleigh House,
Upper Market Street, Eastleigh,
Hampshire, SO50 9YN
Telephone: (023) 8068 8000
Email: engneers@eastleigh.gov.uk

Neighbourhood Services

Scheme:
Rogers Road Edwards Avenue

TRO PROPOSALS

Scale @ A4: NTS	Date:	Drawn by: AGP	Checked by:
Drawing No.: BIF0HH13/008	Project No.: VAR22-23	Rev:	

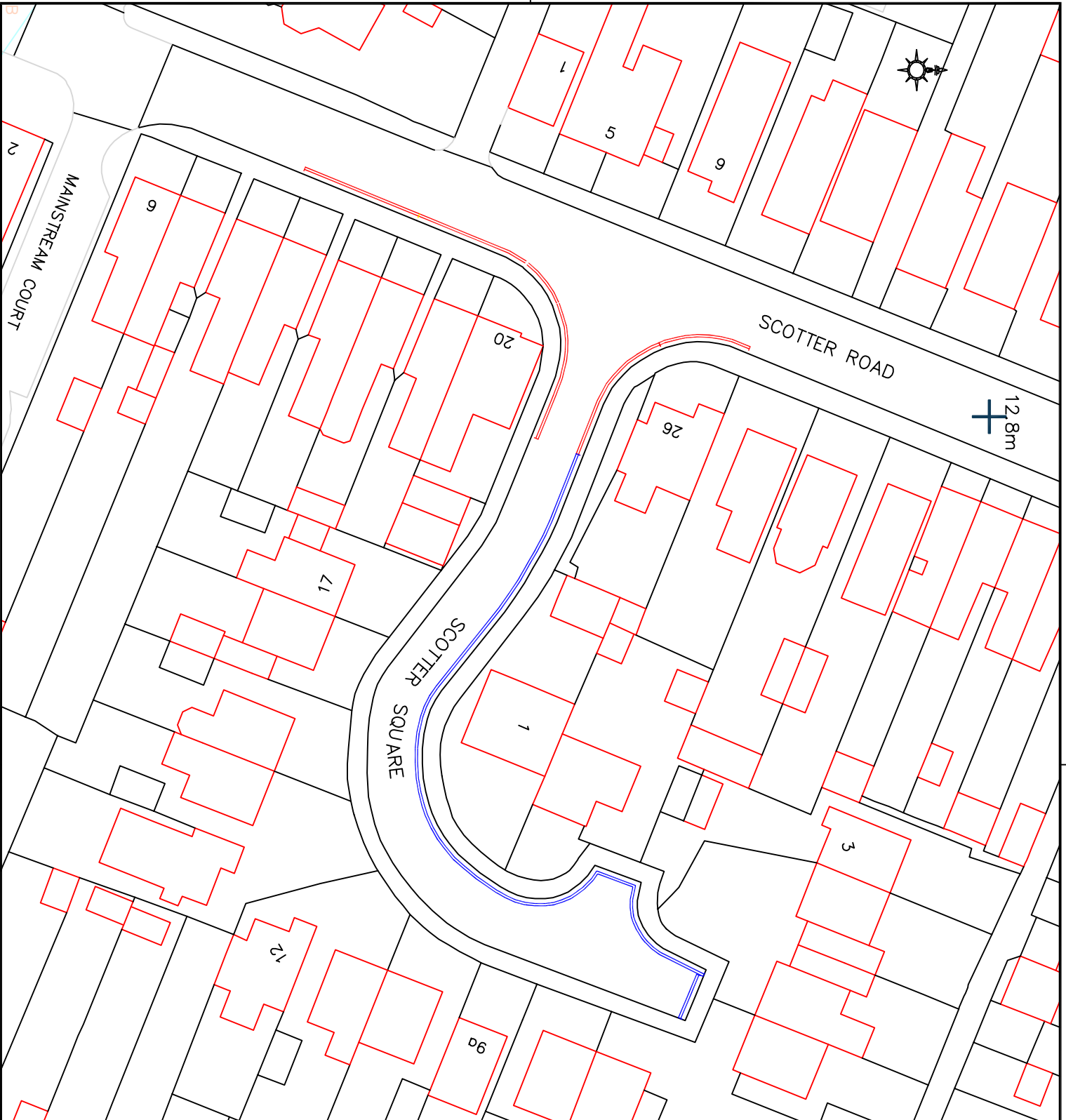

Key to Restriction Types Displayed

- Existing "No Waiting at any Time"
- Proposed "No Waiting at any Time"

STATUS		
Status:		

Rev:	Date:	Description:	CHKd:

Reproduced from the Ordnance Survey mapping with the permission of Her Majesty's Stationery Office (© Crown copyright). Unauthorised reproduction infringes Crown copyright and may lead to prosecution or civil proceedings. License No. 100019422 (2022)



**TRANSPORTATION AND ENGINEERING
NEIGHBOURHOOD SERVICES**
Eastleigh House,
Upper Market Street, Eastleigh,
Hampshire, SO50 9YN
Telephone: (023) 8068 8000
Email: engneers@eastleigh.gov.uk

**Neighbourhood
Services**

Scheme:
Scotter Square

Title:
TRO PROPOSALS

Scale @ A4: **NTS** Date: Drawn by: **AGP** Checked by: **.....**

Drawing No.: **BIF0HH13/004** Project No.: **VAR22-23** Rev: **.....**



Key to Restriction Types Displayed

— Proposed "No Waiting at any Time"

Status:	STATUS
---------	--------

Rev:	Date:	Description:	Chkd:

Reproduced from the Ordnance Survey mapping with the permission of Her Majesty's Stationery Office (© Crown copyright). Unauthorised reproduction infringes Crown copyright and may lead to prosecution or civil proceedings. License No. 100019422 (2022)



**TRANSPORTATION AND ENGINEERING
NEIGHBOURHOOD SERVICES**
Eastleigh House,
Upper Market Street, Eastleigh,
Hampshire. SO50 9YN
Telephone: (023) 8068 8000
Email: engneers@eastleigh.gov.uk

**Neighbourhood
Services**

Scheme:
St Marys Road

Title:
TRO PROPOSALS

Scale @ A4: **NTS** Date: Drawn by: **AGP** Checked by:

Drawing No.: **BIF0HH13/007** Project No.: **VAR22-23** Rev:

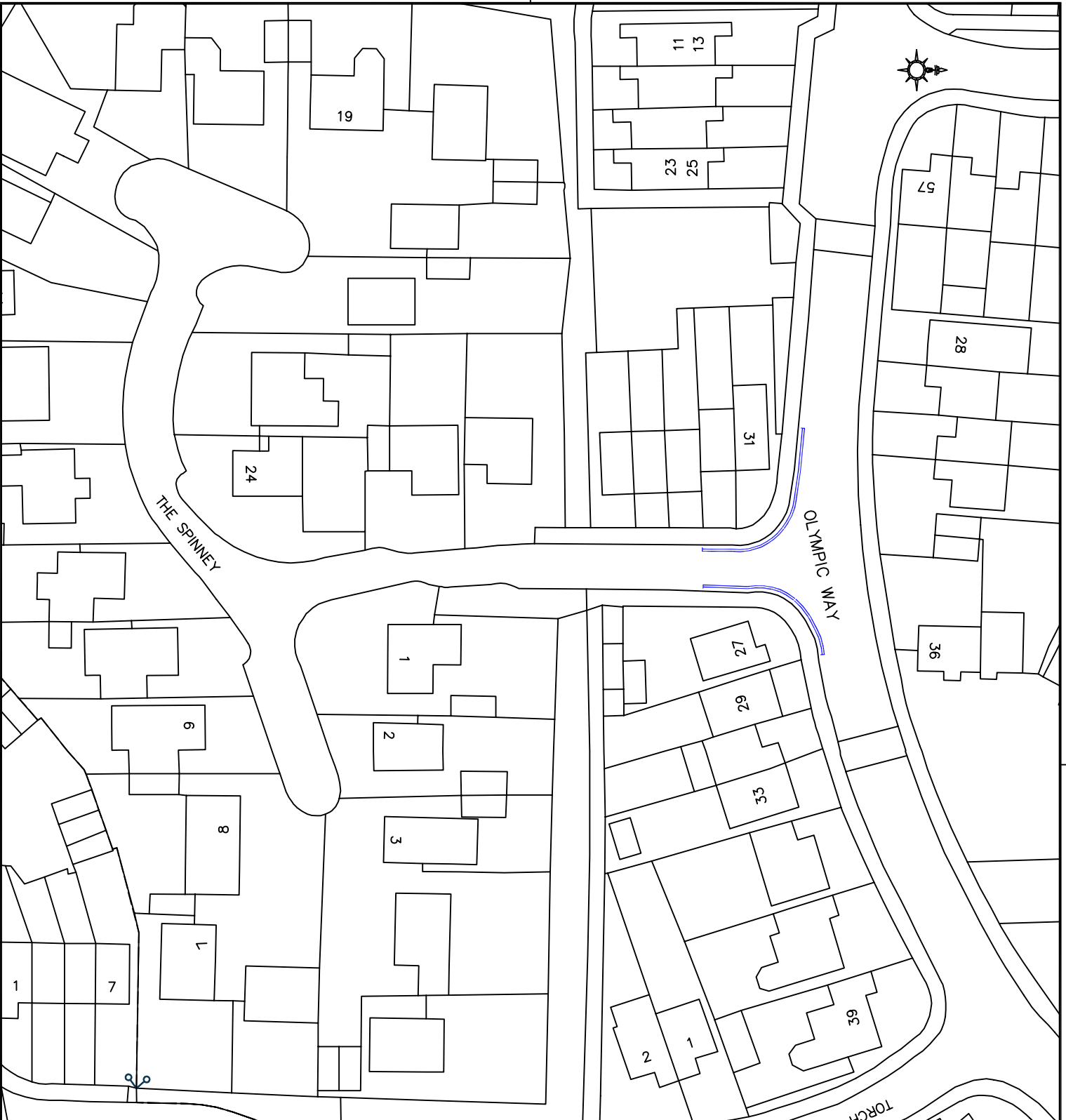

Key to Restriction Types Displayed

— Proposed "No Waiting at any Time"

STATUS

Rev:	Date:	Description:	Chkd:

Reproduced from the Ordnance Survey mapping with the permission of Her Majesty's Stationery Office. Crown copyright. Unauthorised reproduction infringes Crown copyright and may lead to prosecution or civil proceedings. Licence No. 100019622 (2022)



**TRANSPORTATION AND ENGINEERING
NEIGHBOURHOOD SERVICES**
Eastleigh House,
Upper Market Street, Eastleigh,
Hampshire. SO50 9YN
Telephone: (023) 8068 8000
Email: engneers@eastleigh.gov.uk

**Neighbourhood
Services**

Scheme:
The Spinney

Title:
TRO PROPOSALS

Scale @ A4: **NTS** Date: Drawn by: **AGP** Checked by:

Drawing No.: **BIF0HH13/009** Project No.: **VAR22-23** Rev: